

Socket adaptor

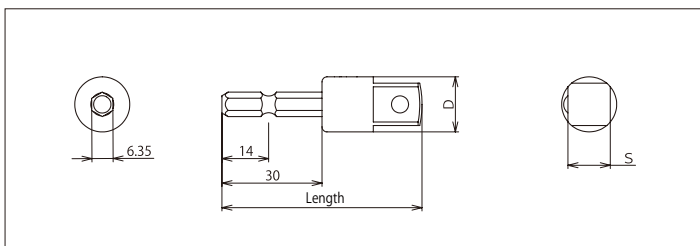

DSA127



Model No.	Angle for inserting [S]		Length (mm)	D (mm)	(Product) weight (g)	JAN code (4963202-)
	mm	in				
DSA95	9.5	3/8	55.0	12.5	27	095143
DSA127	12.7	1/2"	60.0	16.5	48	095181

- Socket adaptor to enable use of your existing socket

Universal socket adaptor



DSUA127

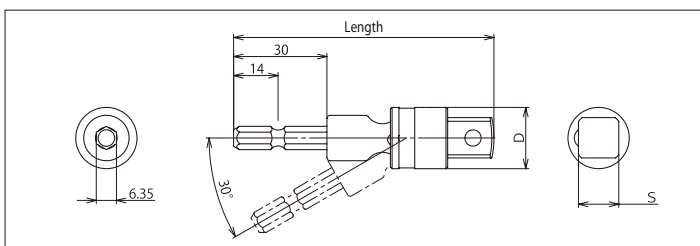

Model No.	Angle for inserting [S]		Swing angle	Length (mm)	D (mm)	(Product) weight (g)	JAN code (4963202-)
	mm	in					
DSUA95	9.5	3/8	30°	78.0	19.3	63	095228
DSUA127	12.7	1/2"	30°	82.0	19.3	73	095266

- Socket adaptor to enable use of your existing socket
- Providing 30° head swing, suitable for work in corners and limited space

Universal socket adaptor (Long)



DSUAL127

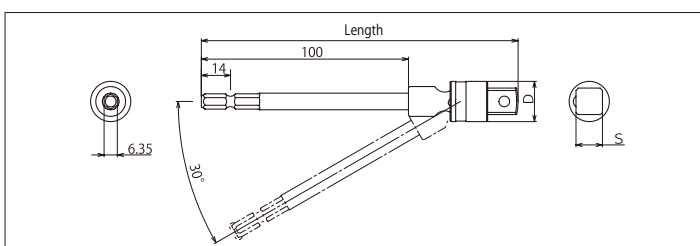

Model No.	Angle for inserting [S]		Swing angle	Length (mm)	D (mm)	(Product) weight (g)	JAN code (4963202-)
	mm	in					
DSUAL95	9.5	3/8	30°	148.0	19.3	92	095303
DSUAL127	12.7	1/2"	30°	152.0	19.3	102	095341

- Socket adaptor to enable use of your existing socket
- The long type is applicable for working with bolt/nut in recessed and elevated positions

High durability and compatibility with 36 V impact screwdriver*
strong-shaft sockets **STLOCK**



Monodzukuri solutions for professionals.
Monodzukuri fun for everyone.

LOBTEX CO.,LTD.

Call center TEL(072)980-1111 FAX(072)980-1166

Homepage <http://www.lobtex.co.jp/>

Description

Four features of

STLOCK: Coined word of "Strong" + "Lock" + "Hexagon (rokkaku in Japanese)"

STLOCK series strong-shaft sockets

STLOCK36 • STLOCK18

 STLOCK 36: 36 V model of STLOCK series (compatible with 18 V)
 STLOCK 18: 18 V model of STLOCK series

STLOCK Point①

Provides break resistance owing to the long shaft effect and use of purpose-specific steel of high durability.

Long shaft

As the shaft is longer than that of conventional models, load applied to the shaft is dispersed, resulting in break resistance. (Torsion effect)
 Applicable with high-power impact screwdrivers because of the use of purpose-specific steel of high durability.
 Target: Standard (High durability type)

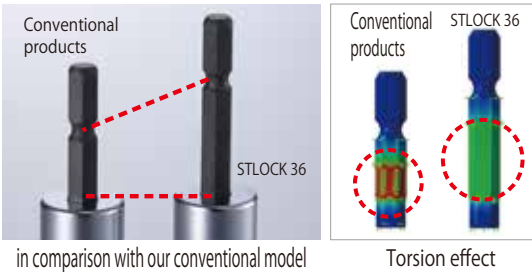
STLOCK Point②

Excellent torque is obtained by hexagon press-fitting.

Hexagon press-fitting

Press-fitting the hexagon shaft into the hexagon hole
 Excellent torque transmission, similar to that obtained via surface contact with the X-DRIVE adjustable angle wrench
 Target: Standard, short, P-cone, form tie, full-thread types



Hex press-fitting part

STLOCK Point③

Lightest weight model in the industry

Light weight

Worker load reduction, resulting in work efficiency improvement
 Up to 30% weight reduction (in comparison with our conventional model)* (* Compared with conventional model DSX24S with 24 mm width across flats)

STLOCK Point④

Identification of size by label color

Size identification on by color

Width across flats is color-coded for easy identification in the field.
 Target: Standard, short, long, light gauge steel, universal, universal long and P-cone types

Other features
Short

Overall length is short. (Short type)

Long

Overall length is long. (Long type)

30° universal

Head swing type

9.5mm 14mm double grooves

The joint part is applicable to two sizes.

Deep hole

The socket hole is long. (Deep socket type)

Features of opening shape
Hexagon

The hexagon type can grip nuts/bolts securely by surface contact, without damaging nut/bolt edges. Principal shape of electric drill socket.

Dodecagon

The dodecagon type is easy to fit over bolts/nuts, resulting in work efficiency improvement. Surface contact does not cause damage to nut/bolt edges.

Surface

Pursuing surface contact, the surface type can securely grip even damaged nuts/bolts. The socket is easy to fit over nuts/bolts, resulting in work efficiency improvement.

Standard socket (High durability type)
Long shaft **Hexagon press-fitting** **Light weight** **Size identification on by color** **Deep hole**

High durability and compatibility with 36 V impact screwdriver

36v

Compatible with impact screwdriver

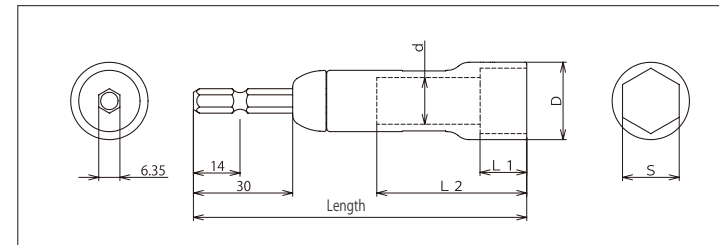

image

- Provides long service life due to torsion effect of the long shaft.
- Torsion/Break resistance and high torque transmission efficiency are obtained when the hexagon shaft is press-fit into the hexagon hole of the socket.
- The lightweight type reduces worker load, enabling work efficiency improvement.
- Deep hole type, applicable to long protruding male threads.

opening shape	Model No.	Width across flats (S) (mm)	Length (mm)	D (mm)	d (mm)	L1 (mm)	L2 (mm)	(Product) weight (g)	JAN code (4963202-)
hexagon	DSX8S	8	100.0	12.7	6.0	12.0	48.0	55	094160
	DSX10S	10	100.0	14.7	8.0	12.0	48.0	51	094405
	DSX12S	12	100.0	17.2	10.0	14.0	47.0	62	094566
	DSX13S	13	100.0	18.2	11.0	14.0	46.5	67	094726
	DSX14S	14	100.0	19.5	12.0	14.0	46.0	73	094887
	DSX17S	17	100.0	23.2	14.0	14.0	45.0	93	095013
	DSX19S	19	100.0	25.2	16.0	14.0	45.0	104	095075
	DSX21S	21	100.0	27.7	18.0	14.0	45.0	120	095112
	DSX22S	22	100.0	28.7	18.0	14.0	45.0	123	095150
dodecagon	DSX24S	24	100.0	31.0	19.0	14.0	44.5	137	095198
	DSX17	17	100.0	23.2	14.0	14.0	45.0	90	095631
	DSX19	19	100.0	25.2	16.0	14.0	45.0	100	095679
surface	DSX21	21	100.0	27.7	18.0	14.0	45.0	113	095716
	DSX17SF	17	100.0	23.2	14.0	14.0	45.0	91	095167
	DSX19SF	19	100.0	25.2	16.0	14.0	45.0	101	095204
	DSX21SF	21	100.0	27.7	18.0	14.0	45.0	115	095242

Short socket

Hexagon press-fitting
Size identification on by color
Short



DS17SS

18v
Compatible with 18 V impact screwdriver

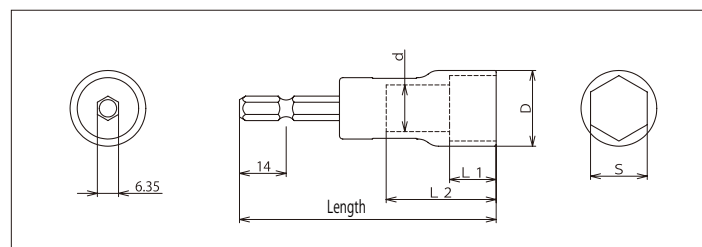

opening shape	Model No.	Width across flats (S) (mm)	Length (mm)	D (mm)	d (mm)	L1 (mm)	L2 (mm)	(Product) weight (g)	JAN code (4963202-)
hexagon	DS8SS	8	77.0	12.7	6.0	12.0	35.0	45	095754
	DS10SS	10	77.0	14.2	8.0	12.0	35.0	38	093842
	DS12SS	12	77.0	16.7	10.0	14.0	35.0	55	094245
	DS13SS	13	77.0	17.7	11.0	14.0	35.0	58	094443
	DS14SS	14	77.0	19.0	12.0	14.0	34.0	62	094603
	DS17SS	17	77.0	22.7	14.0	14.0	33.0	71	094764
	DS19SS	19	77.0	24.7	16.0	14.0	33.0	80	094924
	DS21SS	21	77.0	27.2	18.0	14.0	33.0	90	095389
	DS22SS	22	77.0	28.2	18.0	14.0	33.0	92	095082
	DS24SS	24	77.0	30.5	19.0	14.0	33.0	109	095129

- Socket adaptor to enable use of your existing socket
- Torsion/Break resistance and high torque transmission efficiency are obtained when the hexagon shaft is press-fit into the hexagon hole of the socket.

Socket for light gauge steel

Light weight
Size identification on by color
Long **Deep hole**



DSKT173

18v
Compatible with 18 V impact screwdriver

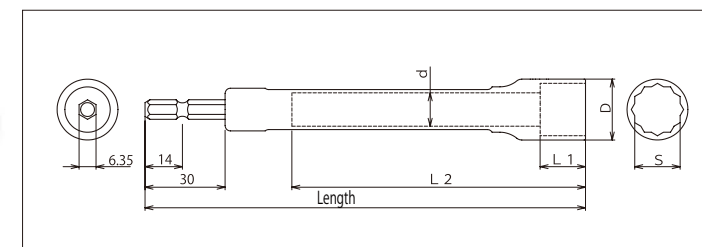

opening shape	Model No.	Width across flats (S) (mm)	Length (mm)	D (mm)	d (mm)	L1 (mm)	L2 (mm)	(Product) weight (g)	JAN code (4963202-)
dodecagon	DSKT173	17	300.0	22.8	12.5	17.0	245.0	154	095525
	DSKT193	19	300.0	24.8	16.0	17.0	245.0	204	095563
	DSKT213	21	300.0	27.3	16.0	17.0	245.0	214	095600
	DSKT175	17	500.0	22.8	12.5	17.0	445.0	223	095648
	DSKT177	17	700.0	22.8	12.5	17.0	645.0	292	095686

- The ultra-long type is suitable for light gauge steel, eliminating the needs for scaffolding
- The lightweight type reduces worker load, enabling work efficiency improvement

Long socket

Light weight
Size identification on by color
Long **Deep hole**



DS17LS

DS17L

18v
Compatible with 18 V impact screwdriver

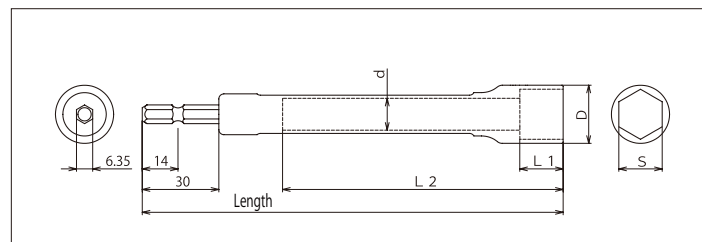

opening shape	Model No.	Width across flats (S) (mm)	Length (mm)	D (mm)	d (mm)	L1 (mm)	L2 (mm)	(Product) weight (g)	JAN code (4963202-)
hexagon	DS17LS	17	165.0	22.8	12.5	17.0	110.0	105	095280
	DS19LS	19	165.0	24.8	16.0	17.0	110.0	135	095327
	DS21LS	21	165.0	27.3	16.0	17.0	110.0	142	095365
dodecagon	DS17L	17	165.0	22.8	12.5	17.0	110.0	105	095402
	DS19L	19	165.0	24.8	16.0	17.0	110.0	135	095440
	DS21L	21	165.0	27.3	16.0	17.0	110.0	142	095488

- The long type is applicable for working with bolt/nut in recessed and elevated positions
- Deep hole type, applicable to long protruding male threads
- The lightweight type reduces worker load, enabling work efficiency improvement.

Universal socket/Universal long socket

Size identification on by color
Long* **30° universal** **Deep hole**
* DSU17LS, DSU19LS, DSU21LS



DSU17S

DSU17LS

18v
Compatible with 18 V impact screwdriver

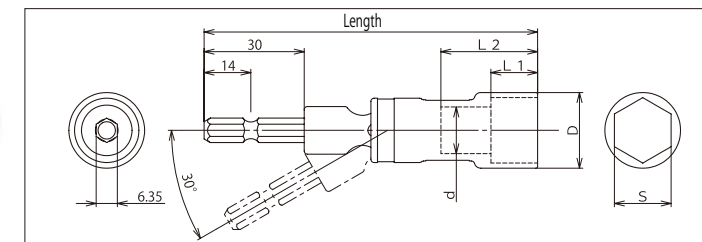

opening shape	Model No.	Width across flats (S) (mm)	Swing angle	Length (mm)	D (mm)	d (mm)	L1 (mm)	L2 (mm)	(Product) weight (g)	JAN code (4963202-)
hexagon	DSU10S	10	30°	100.0	14.2	8.0	12.0	29.0	73	094320
	DSU12S	12	30°	100.0	16.7	10.0	14.0	29.0	77	094481
	DSU13S	13	30°	100.0	17.7	11.0	14.0	29.0	79	094641
	DSU14S	14	30°	100.0	19.2	12.0	14.0	29.0	82	094801
	DSU17S	17	30°	100.0	22.7	14.0	14.0	29.0	87	094962
	DSU19S	19	30°	100.0	24.7	16.0	14.0	29.0	94	095051
	DSU21S	21	30°	100.0	27.2	18.0	14.0	29.0	103	095099
	DSU22S	22	30°	100.0	28.2	18.0	14.0	29.0	104	095136
	DSU24S	24	30°	100.0	30.5	19.0	14.0	29.0	129	095174

- The lightweight type reduces worker load, enabling work efficiency improvement.
- Deep hole type, applicable to long protruding male threads.
- The long type is applicable for working with bolt/nut in recessed and elevated positions.

opening shape	Model No.	Width across flats (S) (mm)	Swing angle	Length (mm)	D (mm)	d (mm)	L1 (mm)	L2 (mm)	(Product) weight (g)	JAN code (4963202-)
hexagon	DSU17LS	17	30°	170.0	22.7	14.0	14.0	29.0	117	095723
	DSU19LS	19	30°	170.0	24.7	16.0	14.0	29.0	122	095761
	DSU21LS	21	30°	170.0	27.2	18.0	14.0	29.0	132	093989

Socket for p-cone



Size Identificati on by color

Deep hole



DSPC

18v

Compatible with 18 V impact screwdriver

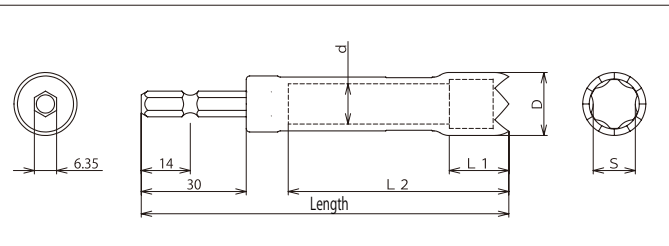

opening shape	Model No.	Width across flats [S] (mm)	Length (mm)	D (mm)	d (mm)	L1 (mm)	L2 (mm)	(Product) weight (g)	JAN code (4963202-)
surface	DSPC	12	105.0	18.0	11.5	12.5	63.0	69	095211

- The claw at the tip keeps mortar from adhering to the P-cone, and catches the nut inside
- Torsion/Break resistance and high torque transmission efficiency are obtained when the hexagon shaft is press-fit into the hexagon hole of the socket.
- Deep hole type, applicable to long protruding male threads

Socket for form tie

18v

Compatible with 18 V impact screwdriver



DSFK (for K-form tie)



DSFIK (for ivy form tie and K-form tie)

- for K-form tie

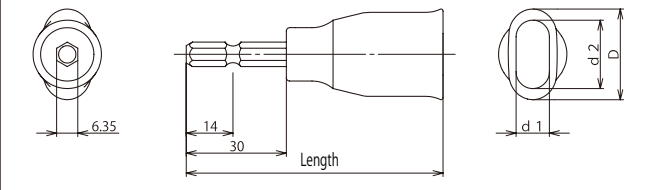

- Both the ivy form tie and K-form tie

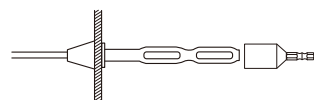
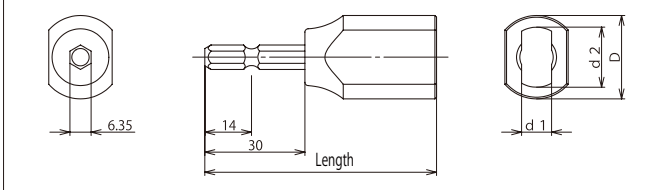

- for K-form tie

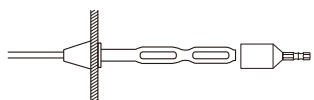

- for K-form tie

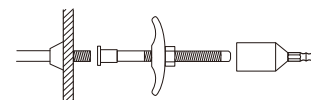

- for ivy form tie

- The bell opening easily fits over nuts and bolts (for K-form tie)
- Both the ivy form tie and K-form tie can be handled with one socket
- Both the ivy form tie and K-form tie can be handled with one socket

Model No.	Use	Length (mm)	D (mm)	d1 (mm)	d2 (mm)	L1 (mm)	(Product) weight (g)	JAN code (4963202-)
DSFK	for K-form tie	77.0	27.2	10	20.5	-	61	095259
DSFIK	Both the ivy form tie and K-form tie	69.5	25.0	9	18	25.0	95	095297

Socket for full-thread

18v

Compatible with 18 V impact screwdriver



DSZN95

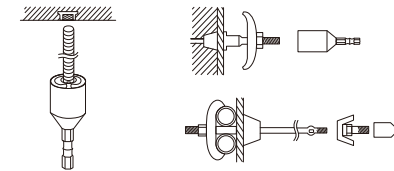

- for all screw bolts
- for form tie
- for p-cone

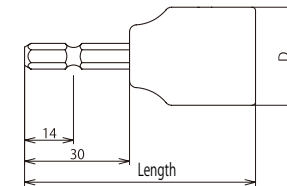
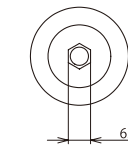

Model No.	Adaptive screw		Length	D	(Product) weight	JAN code (4963202-)
	mm	in				
DSZN79	7.9	5/16	66.0	22.8	84	095372
DSZN95	9.5	3/8	66.0	28.0	120	095419
DSZN10	10	-	66.0	28.0	119	095334
DSZN127	12.7	1/2	66.0	28.0	111	095457

- The roller automatically catches threads, enabling quick fitting. Reverse rotation is enabled.
- Applicable for fitting and removing form ties and P-cones
- Torsion/Break resistance and high torque transmission efficiency are obtained when the hexagon shaft is press-fit into the hexagon hole of the socket.

Socket for hexagon setter/Socket for hexagon setter (with magnet)

9.5mm 14mm double grooves

18v

Compatible with 18 V impact screwdriver



DSH95



DSHM95 (with magnet)

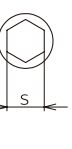
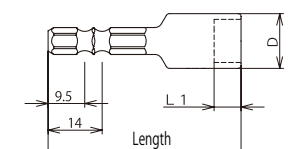
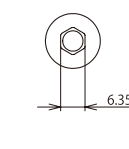

Socket for hexagon setter

opening shape	Model No.	Width across flats [S] (mm)	Length (mm)	D (mm)	L1 (mm)	(Product) weight (g)	JAN code (4963202-)
hexagon	DSH635	6.35 (1/4")	50.0	10.0	5.0	17	095495
	DSH7	7	50.0	11.0	5.0	19	095532
	DSH8	8	50.0	12.0	6.0	20	095570
	DSH95	9.5 (3/8")	50.0	14.2	7.0	31	095617
	DSH10	10	50.0	14.2	7.0	31	095655
	DSH12	12	50.0	17.0	8.0	39	095693
	DSH13	13	50.0	18.0	8.0	42	095730
	DSH14	14	50.0	19.0	9.0	46	095778

Socket for hexagon setter (with magnet)

opening shape	Model No.	Width across flats [S] (mm)	Length (mm)	D (mm)	L1 (mm)	(Product) weight (g)	JAN code (4963202-)
hexagon	DSHM635	6.35 (1/4")	50.0	10.0	2.4	17	094078
	DSHM7	7	50.0	11.0	2.8	19	094368
	DSHM8	8	50.0	12.0	3.5	20	094528
	DSHM95	9.5 (3/8")	50.0	14.2	4.2	29	094689
	DSHM10	10	50.0	14.2	4.2	29	094849
	DSHM12	12	50.0	17.0	5.6	40	095426
	DSHM13	13	50.0	18.0	6.0	50	095068
	DSHM14	14	50.0	19.0	6.4	60	095105

- For fitting and removing hexagon type (hexagon head) screws/bolts
- The joint for electric tool has double grooves (for 9.5 mm and 14 mm), enabling mounting on various types of electric drills
- Equipped with a strong magnet, which can securely hold hexagon type screws/bolts, enabling work efficiency improvement (DSHM)