

## Blind nut rivets **ECO** package Introducing **NEW** package



### ECOLOGY (Reuse)

Packed in reusable resin case

Empty case is reusable for other purposes

### ECONOMY

Affordable small-quantity package

You can purchase qty. you need at any time.

#### KEEP (Easy storage)

- Packed in durable resin case, suitable for storage room.

#### SELECT (Many options)

- Wider lineup of materials and sizes.
- Material identification by label color.
- Unified price per material because of material-based pricing.

## What is "Blind nut rivets"?

Blind Nut Rivet which combines the features of nut and rivet.

- For thin boards where it's difficult to set a tap, for round or square pipes, for plastic boards where welding is not possible.
- With Lobster Nut Rivet Setters, anyone can work securely and contribute to save costs and labor.

#### Housing equipment

Storage, gates, kitchen equipment, steel furniture, etc.

#### Home appliances

TV, stereo, air conditioner, refrigerator, oven, etc.

#### Automobile

Car accessories, side moldings, RV car step, etc.

#### Other

Electrical work, agricultural equipment, interior and exterior work, solar equipment, etc.

#### Work procedure

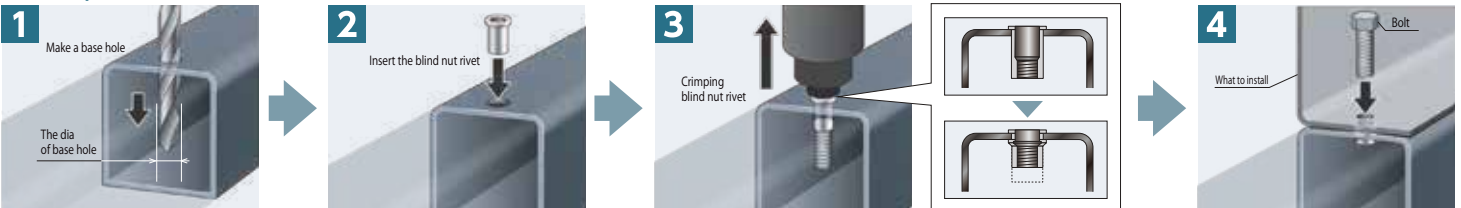

#### Example of use



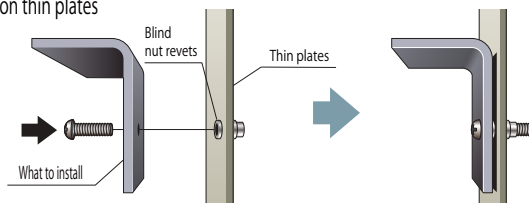



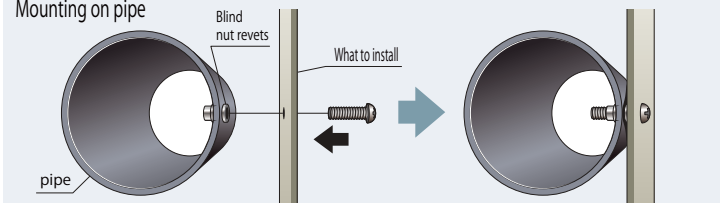







Mounting on thin plates



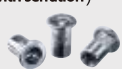



Mounting on pipe



## Blind nut rivet ECO package

	material	Flange shape	Model No.	Applicable screw	Thickness of base material mm	Base hole mm	Flange diameter mm	Flange thickness mm	Q'ty / carton	Retail / User prices	JAN - Code 4963202-
	Aluminum		NAD4MP	M4×0.7	1.0~2.0	φ6.1	φ9.0	0.8	35	open price	001762
			NAD5MP	M5×0.8	1.0~3.2	φ7.1	φ10.3	1.0	30	//	001779
			NAD6MP	M6×1.0	1.0~3.2	φ9.1	φ12.3	1.5	25	//	001786
			NAD8MP	M8×1.25	1.0~3.2	φ11.1	φ14.3	1.5	15	//	001793
	Aluminum		NAK4MP	M4×0.7	1.0~2.0	φ6.1	φ6.8	0.5	35	//	001809
			NAK5MP	M5×0.8	1.0~3.2	φ7.1	φ8.0	0.5	30	//	001816
			NAK6MP	M6×1.0	1.0~3.2	φ9.1	φ10.0	0.5	25	//	001823
			NAK8MP	M8×1.25	1.0~3.2	φ11.1	φ12.0	0.5	15	//	001830
	Steel		NSD4MP	M4×0.7	1.0~2.0	φ6.1	φ9.0	0.8	35	//	002103
			NSD5MP	M5×0.8	1.0~3.2	φ7.1	φ10.0	1.0	30	//	002127
			NSD6MP	M6×1.0	1.0~3.2	φ9.1	φ12.3	1.5	25	//	002158
			NSD8MP	M8×1.25	1.0~3.2	φ11.1	φ14.0	1.5	15	//	002189
	Steel		NSK3MP	M3×0.5	1.0~2.0	φ5.1	φ6.0	0.5	35	//	002288
			NSK4MP	M4×0.7	1.0~2.0	φ6.1	φ6.8	0.5	35	//	002295
			NSK5MP	M5×0.8	1.0~3.2	φ7.1	φ8.0	0.5	30	//	002301
			NSK6MP	M6×1.0	1.0~3.2	φ9.1	φ10.0	0.8	25	//	002318
			NSK8MP	M8×1.25	1.0~3.2	φ11.1	φ12.0	0.8	15	//	002363
			NSK10MP	M10×1.5	1.0~4.0	φ13.1	φ14.0	0.8	10	//	002394
	Steel		NSD4RMP	M4×0.7	0.5~2.5	φ6.1	φ9.0	0.8	35	//	002196
			NSD5RMP	M5×0.8	0.5~2.5	φ7.1	φ10.0	1.0	30	//	002257
			NSD6RMP	M6×1.0	1.0~3.5	φ9.1	φ13.0	1.5	25	//	002264
			NSD8RMP	M8×1.25	1.0~4.0	φ11.1	φ14.5	1.5	15	//	002271
	Steel		NSK4RMP	M4×0.7	0.5~2.5	φ6.1	φ7.0	0.5	35	//	002400
			NSK5RMP	M5×0.8	0.5~2.5	φ7.1	φ8.0	0.5	30	//	002417
			NSK6RMP	M6×1.0	1.0~3.5	φ9.1	φ10.0	0.5	25	//	002448
			NSK8RMP	M8×1.25	1.0~4.0	φ11.1	φ12.0	0.5	15	//	002455
			NSK10RMP	M10×1.5	1.0~4.0	φ13.1	φ14.0	0.5	10	//	002462
	Stainless Steel		NTK4MP	M4×0.7	0.3~1.0	φ6.1	φ7.0	0.7	12	//	002479
			NTK5MP	M5×0.8	0.3~1.5	φ7.1	φ8.0	0.7	10	//	002486
			NTK6MP	M6×1.0	0.3~2.0	φ9.1	φ10.0	0.7	10	//	002493

## Applicable tools of Blind nut rivet

Variety	Model No.	Applicable blind nut rivet						Retail / User prices	
		M3	M4	M5	M6	M8	M10		
Nut rivet setter (hand)	HND005 	○	○	△	▲	—	—	open price	△: Cannot work Stainless steel ▲: Cannot work Steel and Stainless steel
	HND010 	—	—	○	○	○	○	//	
Nut rivet setter (attachment)	@N17d 	—	○	○	○	—	—	//	
Nut rivet setter (pneumatic)	N1A2 	OP	○	○	○	○	○	//	OP: It corresponds with optional parts
Pocketable nut rivet setter	HNC-R 	—	●	●	●	—	—	//	●: Only compatible with bundled size knurled nuts (large flanges)

### IMPORTANT SAFETY INSTRUCTIONS

● Use by considering the working condition. ● Before starting work, read the instruction manual of Rivet Nut Setter carefully.

● Specifications may be changed for improvement of the product without prior notices. ● Since dimensions, weights, etc. are nominal, there possibly are changes of some numerical values. ● Listed prices do not include VAT.

**Monodzukuri solutions for professionals.**  
**Monodzukuri fun for everyone.**

**LOBTEX CO.,LTD.**

Call center TEL(072)980-1111 FAX(072)980-1166

Homepage <http://www.lobtex.co.jp/>